

Instruction

**Adjustment of wires and gas cylinders
for tilt & recline**



Enable joy of life

Adjustment of wires and gas cylinders for tilt and recline

Wires and gas cylinder – Description of function:

Gas cylinders for tilt and recline are connect with wires to the release handles.
The handles are mounted at the push bow at the back of the wheelchair.
At the lower end the wire is connected to a release mechanism.
When operating the handle the Gas cylinder release lever will push the Gas cylinder pin into the Gas cylinder and the Gas cylinder will start working.
By letting the handle go the Gas cylinder will stop immediately in the desired position.

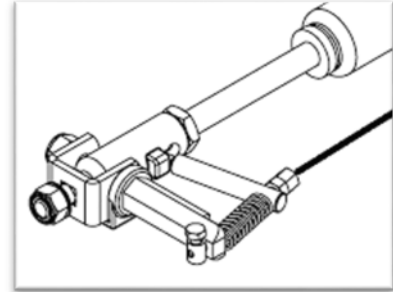

The picture on the right side shows the release handles for tilt and recline and their outgoing wires.
At the push bow next to the handles you will find Icons showing this function.



Release handles

The picture on the right side shows a Gas cylinder with the Gas cylinder pin at the end and a locking nut.



In this picture you see the release-mechanism and its single parts.

Wire fixation clamp

Spring

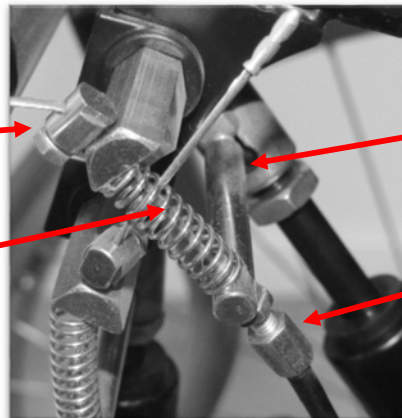

Gas cylinder release lever

Wire adjustment wheel

By pulling the release handle the spring will be compressed and the lever will work against the pin to operate the Gas cylinder.

Adjustment of wire tension:

When a chair leaves Alu Rehab's factory, Gas cylinders and wires for tilt and recline are finally adjusted and tested.

By using the chair and its function on a daily base, a relaxation of the tension may occur.

When noticing this a new adjustment of the tension is needed.

To adjust the tension you have 3 possibilities:

1. Adjust the tension by turning the little wheel you can find at the release handle
2. Adjust the tension at the adjustment wheel you can find at the lower end of the wire close to the release mechanism
3. Open the wire fixation clamp and pull the wire a bit more out to increase the tension and tighten the clamp nut firmly after.



Adjustment of Gas cylinders:

If you notice that a gas cylinder will not keep its position when the release handles are not operated, you need to adjust the starting position of the gas cylinder stroke.

This you can do as follow:

Tilt:

1. Move the seat in horizontal position
2. Loose the Gas cylinder in the bracket at the seat frame under the seat.
The cylinder has to move free in the bracket.
3. Open the locking nut at the end of the Gas cylinder so far you can turn the Gas cylinder a bit out.
4. Now turn the cylinder a bit out.
By doing this the Gas cylinder pin will touch the gas cylinder lever only when operating the release handles.
Test if the gas cylinder keeps its position by operating the release handle for tilt function.
5. When the Gas cylinder keeps its position tighten the locking nut again and fix the Gas cylinder in the upper bracket at the seat frame.

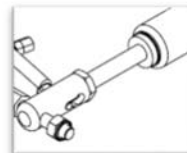
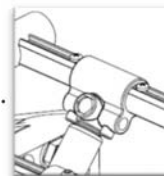

Recline:

1. Adjust the back in a middle position backwards. The Gas cylinder should have a 50% stroke left.

2. Pull the quick release axle out of the bracket where the Gas cylinder head is attached to the back frame.

The picture on the right shows a Netti III bracket. At the 4U-Chairs it looks a bit different but the functionality is the same.



3. Now open the locking nut at the lower end of the Gas cylinder so far, you can turn the Gas cylinder a bit out of the release mechanism.

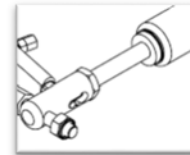

4. Now turn the cylinder a bit out.

By doing this the Gas cylinder pin will touch the gas cylinder lever only when operating the release handle. Put the Gas cylinder head back into the bracket and test if the gas cylinder keeps its position when operating the release handle for recline.

5. When the Gas cylinder keeps its position tighten the locking nut again and fix the Gas cylinder in the bracket with the quick release axle.

The wire tension should be checked regularly.

We recommend to lubricate the Gas cylinder lever at the release mechanism periodically with the product HSW 100 of the company Wuerth.

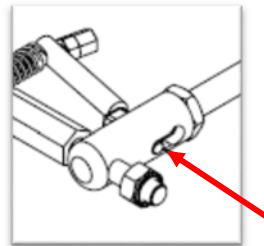

IN DIALOGUE WE CREATE
SIMPLE SOLUTIONS AND
ENABLE JOY OF LIFE

MD 0121UK-2015-11



This product confirms to 93/42/EEC for medical products

FEEL FREE TO CONTACT US:



Alu Rehab A/S
Bedriftsvegen 23
N-4353 Klepp Stasjon

T: +47 51 78 62 20
post@My-Netti.com

Alu Rehab ApS
Kløftehøj 8
DK-8680 Ry

T: +45 87 88 73 00
F: +45 87 88 73 19
info@My-Netti.com

My-Netti.com